

OSCAR FREESTANDING WOODBURNER FLUE-GUARD INSTALLATION PROCEDURE (Ver.2)

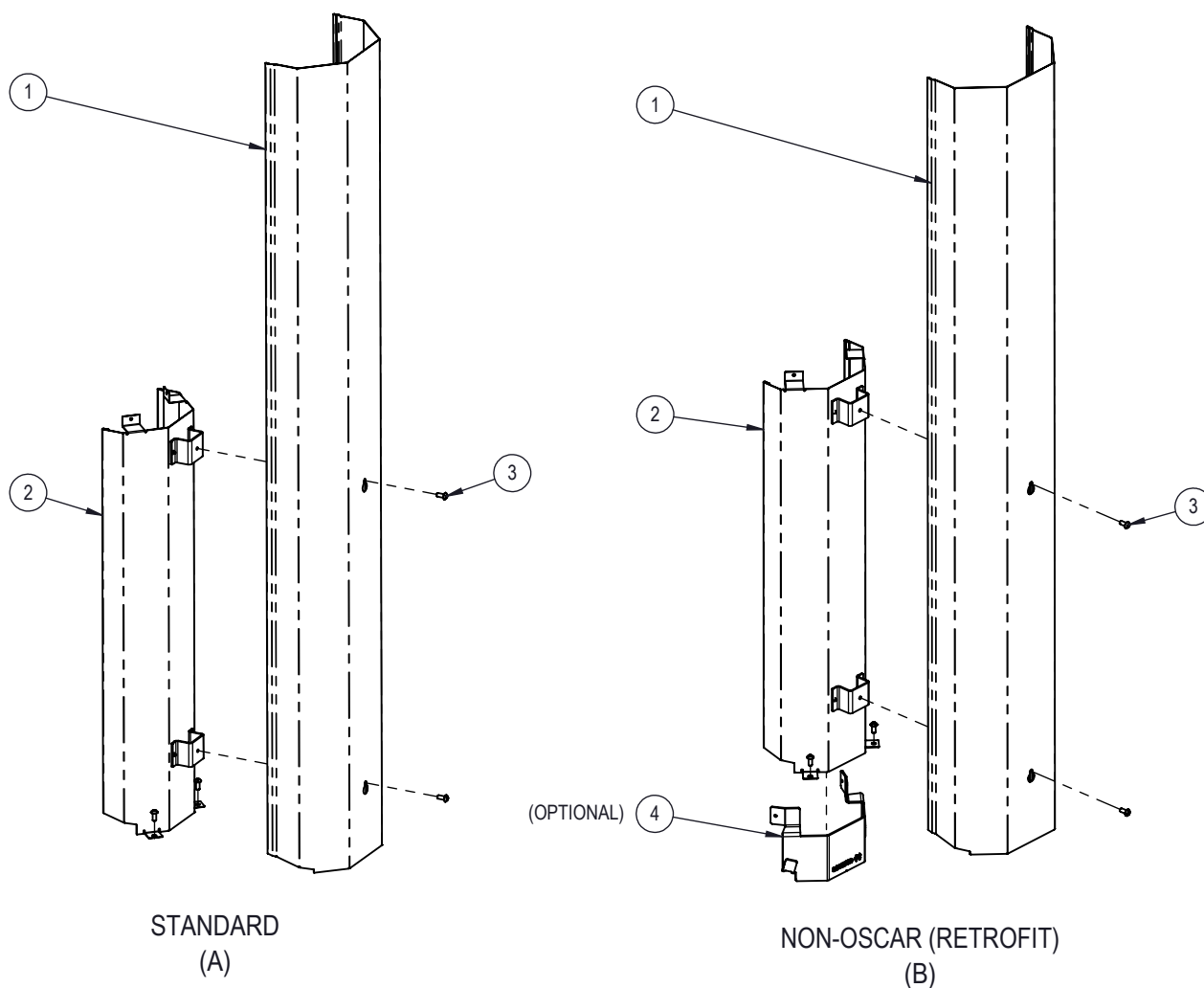

	PARTS DESCRIPTION	QUANTITY
1	OUTER FLUE-GUARD	1
2	INNER FLUE-GUARD	1
3	M5x12 BUTTON-HEAD SOCKET SCREW	4
4	NON-OSCAR FLUE-GUARD BOTTOM BRACKET (OPTIONAL)	1

TOOLS REQUIRED	QUANTITY
CORDLESS DRILL	1
3.3mm DIA. DRILL BIT	1
3mm ALLEN KEY	1
RIVETER	1
3.2mm Dia. POP-RIVET (73STST 4-1)	4

A. BASIC INSTALLATION OF STANDARD OSCAR FLUE-GUARD

STEP 1:

Position the Inner Flue-guard at the back of the flue as shown below then screw the bottom side M5x12 Buttonhead socket screws.

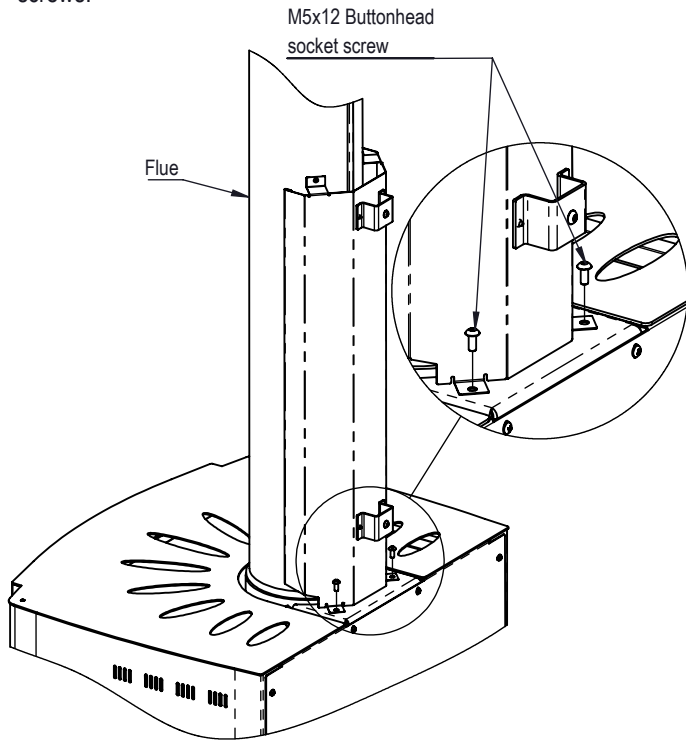

STEP 2:

Using the rivet holes above the flue guard, drill a 3.3mm diameter hole on each sides of the flue then install the 3.2mm Pop-rivets (73STS 4-1).

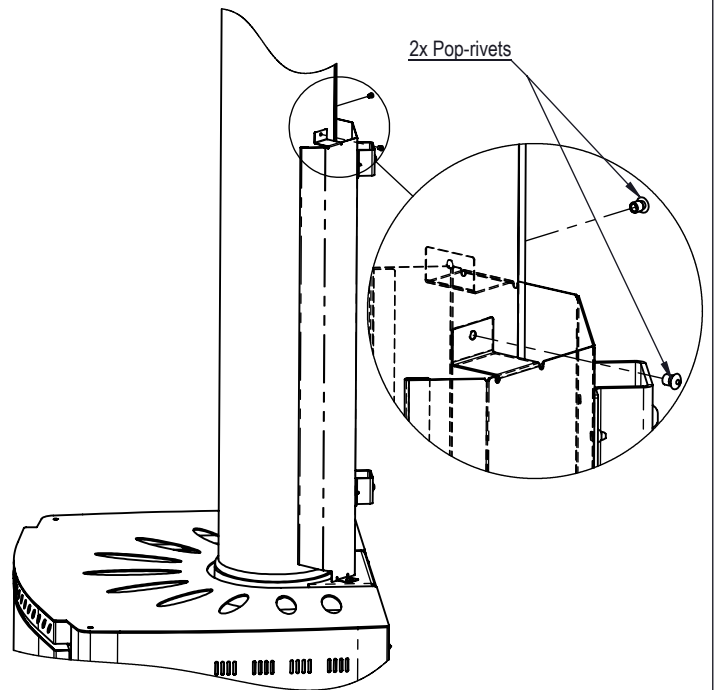

STEP 3:

Loosen the two M5x12 Buttonhead socket screws at the back of the Inner Flue-guard, then attach the Outer Flue-guard by inserting the screws into the key-holes. Tighten the screws after.

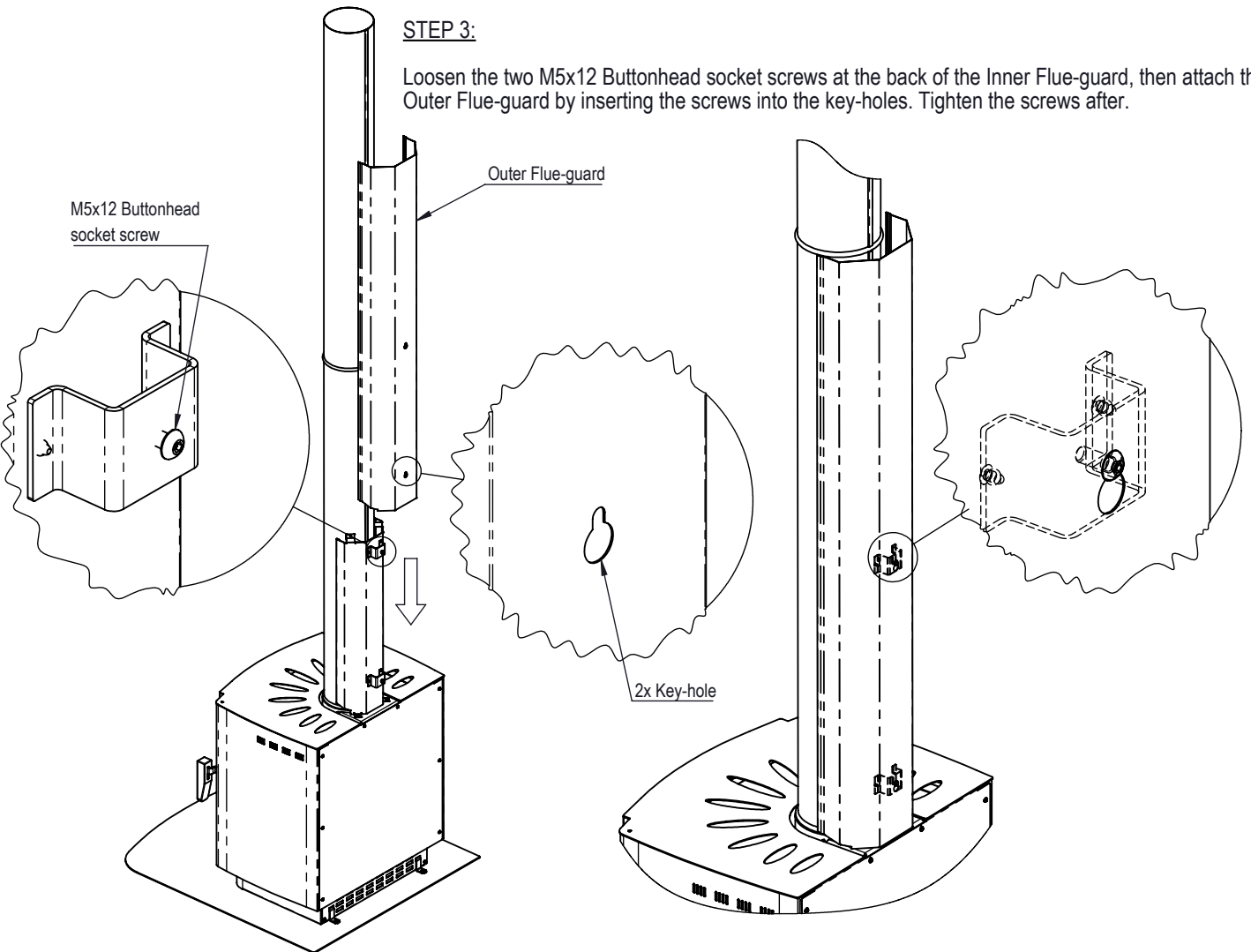

B. INSTALLATION OF FLUE-GUARD FOR NON-OSCAR UNITS

STEP 1:

Mark the centre of top of the fireplace behind the flue, then place and align the centre of the bracket on the marked line. When set, drill a 3.3mm diameter hole on the flue thru the rivet holes of the bracket, then install pop-rivets.

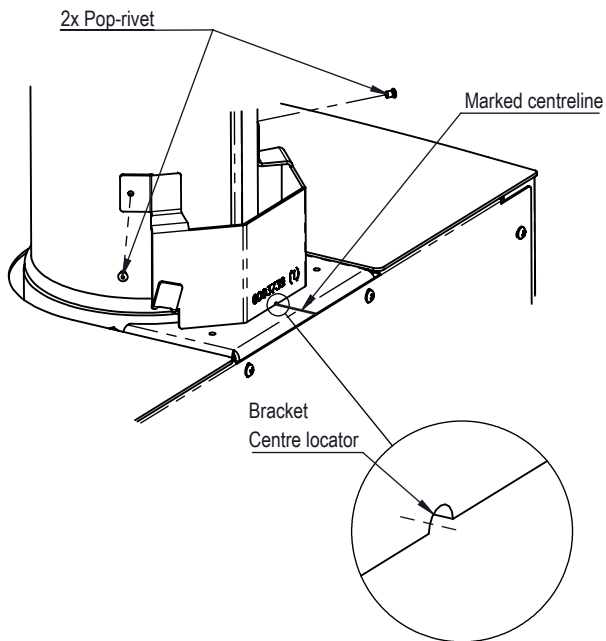

STEP 2:

Slide the Inner flue-guard into the bottom bracket clips

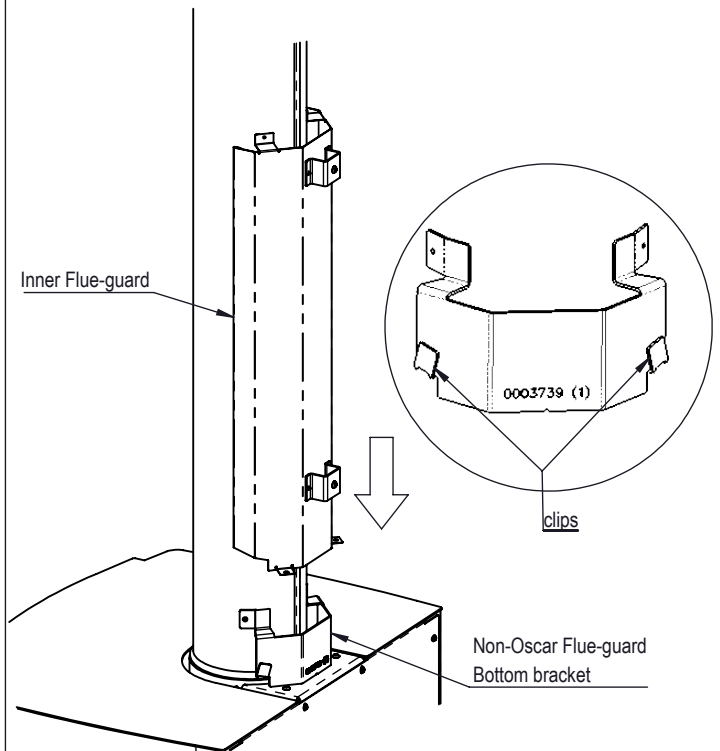

STEP 3:

Drill two holes on the flue on top of the flue-guard bracket through its holes, then install rivets.

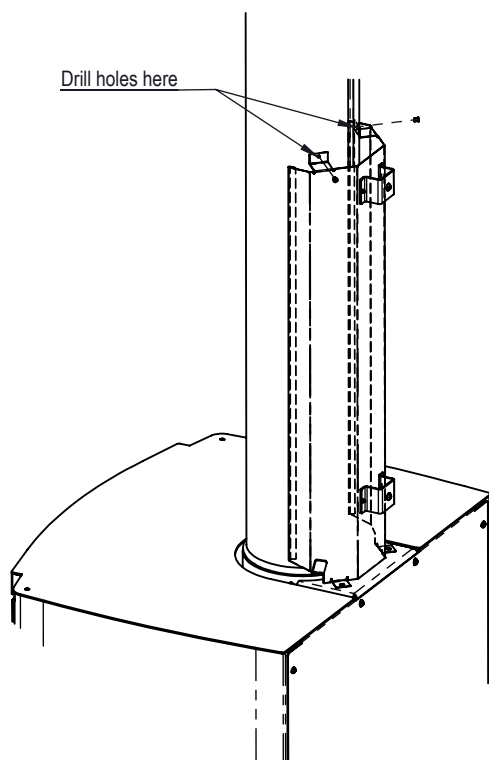

STEP 4:

Loosen the two M5x12 Buttonhead socket screws at the back of the Inner Flue-guard, then attach the Outer Flue-guard by inserting the screws into the key-holes. Tighten the screws after.

